

DECO CARD CASE KIT

Preparation

Tweezers, Wet tissue

Not necessary but convenient

Tray for parts,
Craft bond glue, Scissors

Cautions ※ Please read carefully before you start.

Particles in the kit will cause injury if children accidentally swallow them. When children enjoy this kit please work together with adult.

* Please check if the contents are all included.

* You will need:

- tweezers - for detail work.
- scissors - for cut the plastic bag.
- craft bond glue - for attaching the parts in case the parts are removed from the body.
- wet tissue - for cleaning your hands or the table.
- an apron - to protective your clothes.

<Magical whip>

Drying time depends on temperature, humidity and size. Do not touch the whip until it dries fully. It may take more than 2-3 days to dry the part which is not exposed to air. The smell of the whip may disappear after it dries. The whip might shrink due to the evaporation after drying. The whip may discolor after it's exposed to the air for a long time. Decoration part colors may occur color transfer onto the whip. Metal parts may get rusty by whip. If metal parts are not coated, they may get rusty with magical whip. Wipe a nozzle tip off with wet wipes etc. after use. If the whip on a nozzle tip dries, it may difficult to clean it. We recommend using the magical whip as soon as possible after opening. Store in a cool, dry place away from direct sunlight.

Contents



How to use the card case

※ The following picture is not included in this kit.

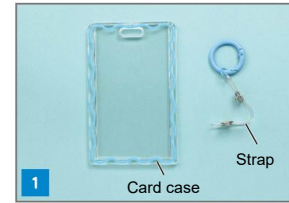

1 Take off the strap from the card case.

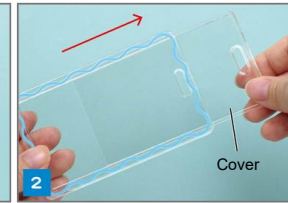

2 Slide the cover in the direction of the arrow and remove it.



Basic

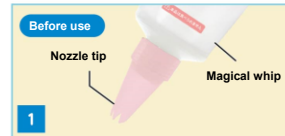

1 Open a cap and remove an inner lid. Attach a nozzle tip.



2 Remove the nozzle tip, and close the cap.

TIP

Please wipe the nozzle tip with wet tissue after use. Otherwise, the whipped cream will dry in the nozzle.

HOW TO MAKE

1 Take off the strap from the card case.

2 Squeeze the magical whip on the case.

TIP

The surface of the whipped cream will dry in 10 ~ 20 min after squeezing.

3 Put the decorative parts on whipped cream before the cream dries.

Done ♪

TIP

It takes 2 - 3 days until the whipped cream dries completely.

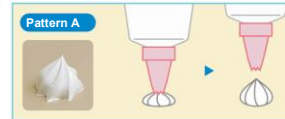
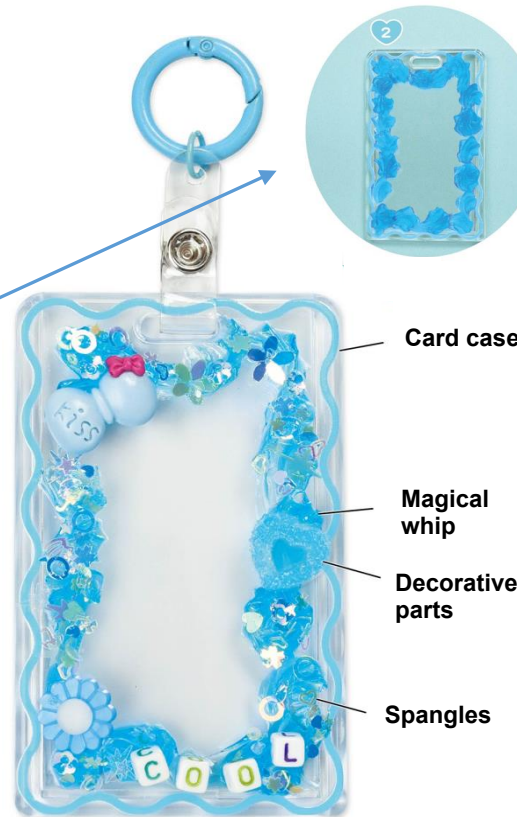

Pattern A Squeeze the magical whip out, and pull the tube up.

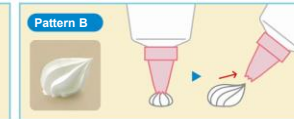

Pattern B Squeeze the magical whip out, and pull the tube up and to the right slowly.

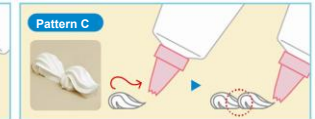

Pattern C Squeeze the magical whip out so that the whip place on the end of the previous whip.



Pattern D Keep squeezing the magical whip at a lower position. When finishing squeezing, move back the tube a bit.

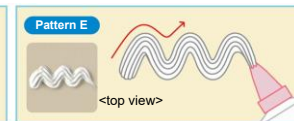

Pattern E Squeeze the magical whip out as shown in the picture above.

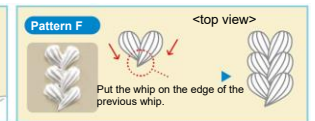

Pattern F Squeeze the magical whip out, and place the whip on the edge of the previous whip.



Pattern G Squeeze the magical whip out as shown in the picture above so as not to make a hole in the middle.



Pattern H Squeeze the magical whip out as shown in the picture above, and pull the tube up.



Pattern I Keep squeezing the magical whip while maintaining height, and pull the tube up.